

## ACCESSORIES AND OTHER INFORMATION

---



---



---



---

**DELIVERY**    Yes    No    Note: We use couriers for delivery and assistance with unloading will be required.

**ENTER YOUR DETAILS BELOW AND LEAVE YOUR PLAN WITH US FOR AN OBLIGATION FREE QUOTE.**

Name: \_\_\_\_\_ Date: \_\_\_\_\_

Address: \_\_\_\_\_

Suburb: \_\_\_\_\_

Phone: \_\_\_\_\_ Fax: \_\_\_\_\_ Email: \_\_\_\_\_

Requested Delivery Date: \_\_\_\_\_

### WHAT YOU GET AT Kitchen Box DIY Centre

- Kitchens designed for DIY
- Full installation service available on request
- Delivered to your door or pick up from our warehouse
- Solid units constructed with 16mm HMR Melamine
- Pre doweled construction no gluing or nailing required
- Full screw & dowel construction / no flimsy cam fixing
- All holes pre-drilled and countersunk
- All associated hardware of the highest quality
- All drawers with metal sides (with the option of a full soft close system)
- All hardware supplied to complete your kitchen
- Hundreds of styles and colour combinations available for benchtops & Doors
- Total after sales support from Kitchen Box.

How did you hear about us?

- External Signage       Internet  
 Yellow Pages         Recommendation  
 Local Paper             Other: \_\_\_\_\_

Niddrie Showroom and Warehouse  
 521 Keilor Road Niddrie 3042  
 P: 03 9374 1770 F: 03 9374 1771  
 E: niddrie@kitchenbox.com.au  
 W: kitchenbox.com.au



## Plan Your Project

Using the Kitchen Box Cabinet Guide, mark the position of the units including the position of the fridge, sink, stove, range hood and also the doors and windows.

**IMPORTANT:** If at any point you need help bring your measurements and ideas into our showroom and one of our consultants will be more than happy to help you.

**DESIGN CHECKLIST:**

Include the items on this checklist to help us achieve an accurate quotation.

- Wall measurements       Appliance positions       Overheads  
 Cabinet positions       Window & doors       Seen ends/Filler panels  
 Drawers       Fridge

When completed your plan could look like this:

**Standard measurements**  
 Standard Benchtop Depth: 600mm  
 Breakfast Bar / Island Bench Depth: 650mm to 1150mm

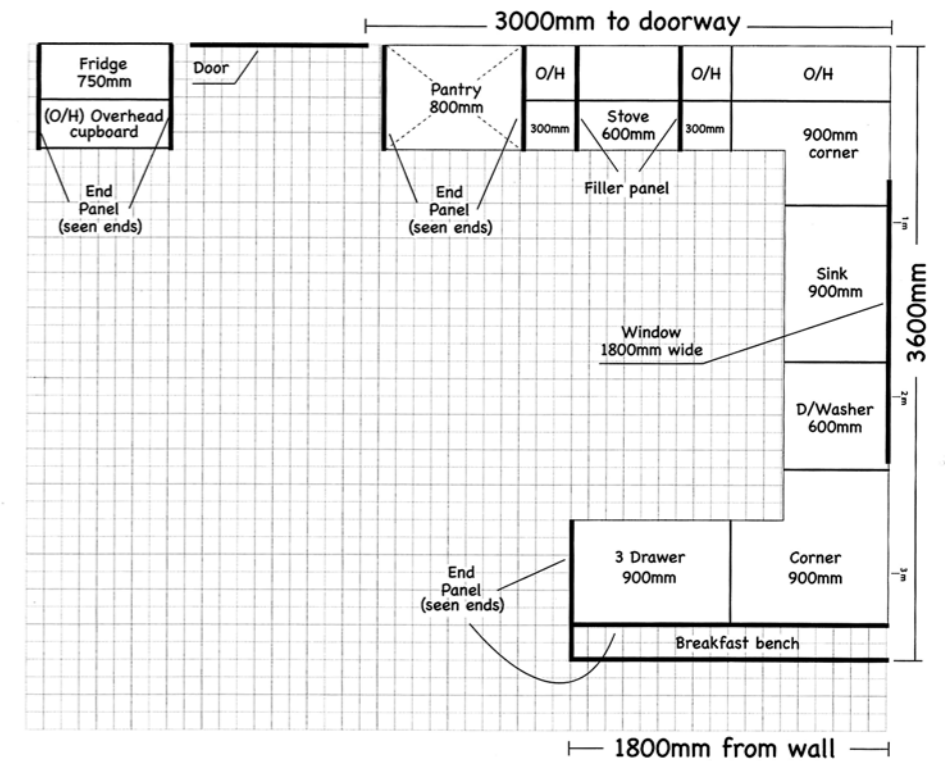
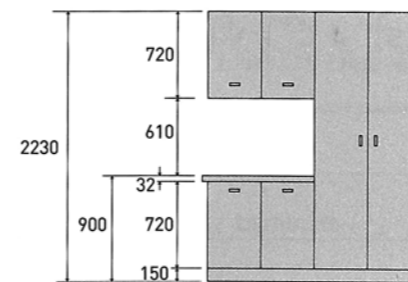

**TIP:** Stove tops should be placed a minimum of 250mm away from a side or pantry. If you need any help, don't hesitate to contact one of our instore consultants

# Plan your kitchen

Using the graph page below, plan and mark out the layout of your kitchen.

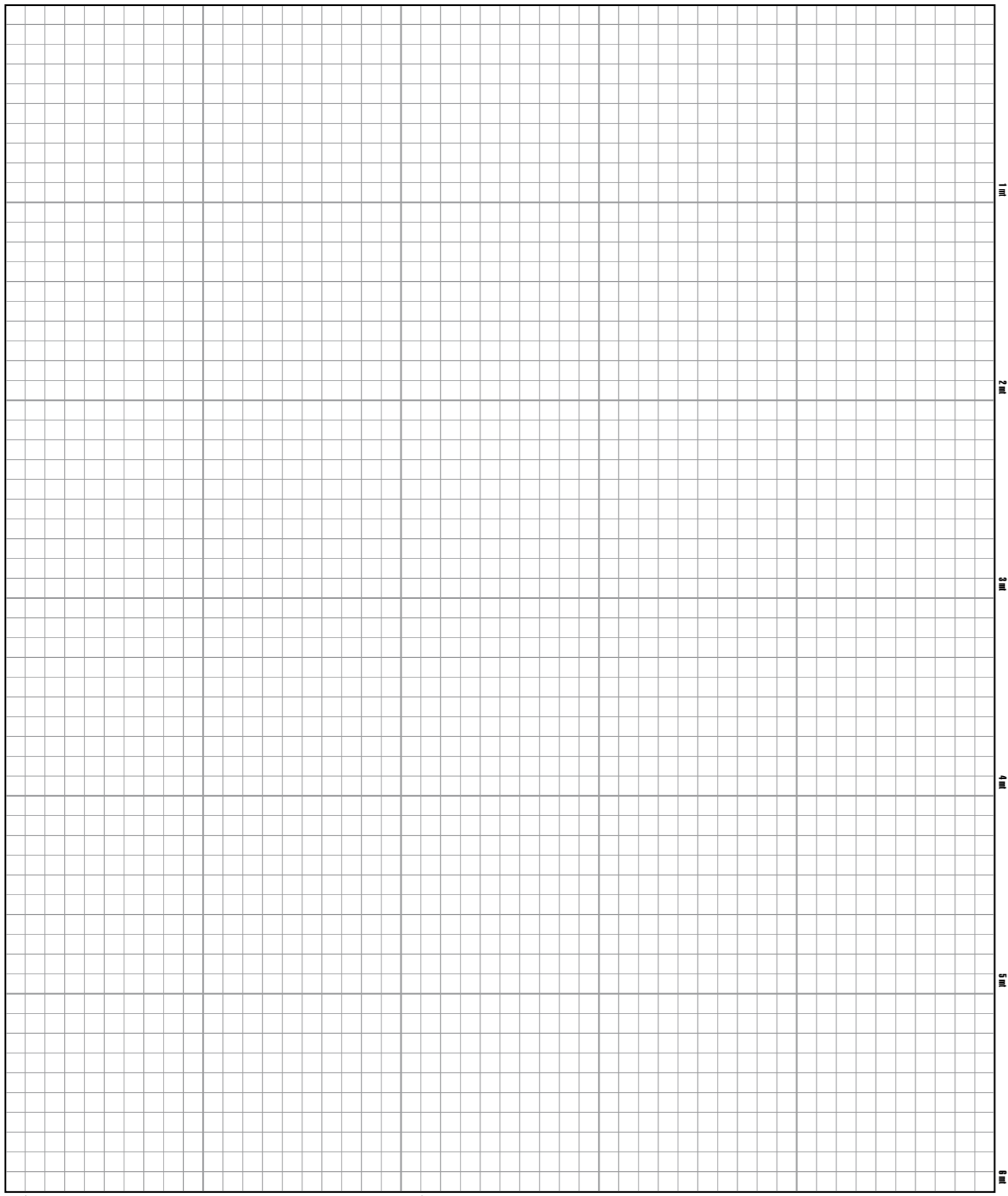

## Design Your Project

### DOORS

Type of doors:  Laminate/Melamine  Vinyl  Other: \_\_\_\_\_

Colour of doors: \_\_\_\_\_

Style of doors (Vinyl Only):  Style 1  Style 2  Style 3  Style 4  
 Glass Frame (Vinyl)  Glass Door (Aluminium)

Design Name (if known): \_\_\_\_\_

### BENCHTOPS

Surface Type:  Laminate  Other \_\_\_\_\_

Colour/Brand of benchtop (if known): \_\_\_\_\_

Benchtop edge:  Square  Round edge (postformed)

### OVEN

Quote: Code: \_\_\_\_\_

Type:  Under Bench  width: \_\_\_\_\_

Wall Tower 

Free Standing  width: \_\_\_\_\_

**RANGEHOOD**  Quote: Code: \_\_\_\_\_

Slide out:  600mm  900mm Canopy:  600mm  900mm

Fixed:  600mm  900mm

### FRIDGE

Overhead Cupboard:  Yes  No width: \_\_\_\_\_  750  800  850  900

1000 Special Size: \_\_\_\_\_

**DISHWASHER**  Quote: Code: \_\_\_\_\_

Yes  No  width: 600mm Special width: \_\_\_\_\_